



Wattle Park, SA
12 Gordo Avenue

3 BED
2 BATH
3 CAR



City & Coastal Views A Fairyland Of Lights By Night
Ideally located in one of Adelaide's finest Eastern Foothills suburbs, within aprox10 minutes of the CBD, integrated with calm surrounds, offering lifestyle without compromise, designed for a family to live in comfort, this instantly appealing , architecturally designed Executive Family Home with immense visual appeal is individual and luxuriously appointed, representing the perfect solution for the active family. Your dream home awaits you.

Loaded with appeal, offering relaxed family living, complete with a sense of tranquillity and privacy, set amidst picturesque rolling landscape with all the benefits of designer living.

Attributes include : A feature entry foyer sets the scene for this stunning home opening onto

SOLD

Contact: Justin Gall
0418 848 309

Type: House

Sold Date: 25/01/2019

<http://www.justingall.com>

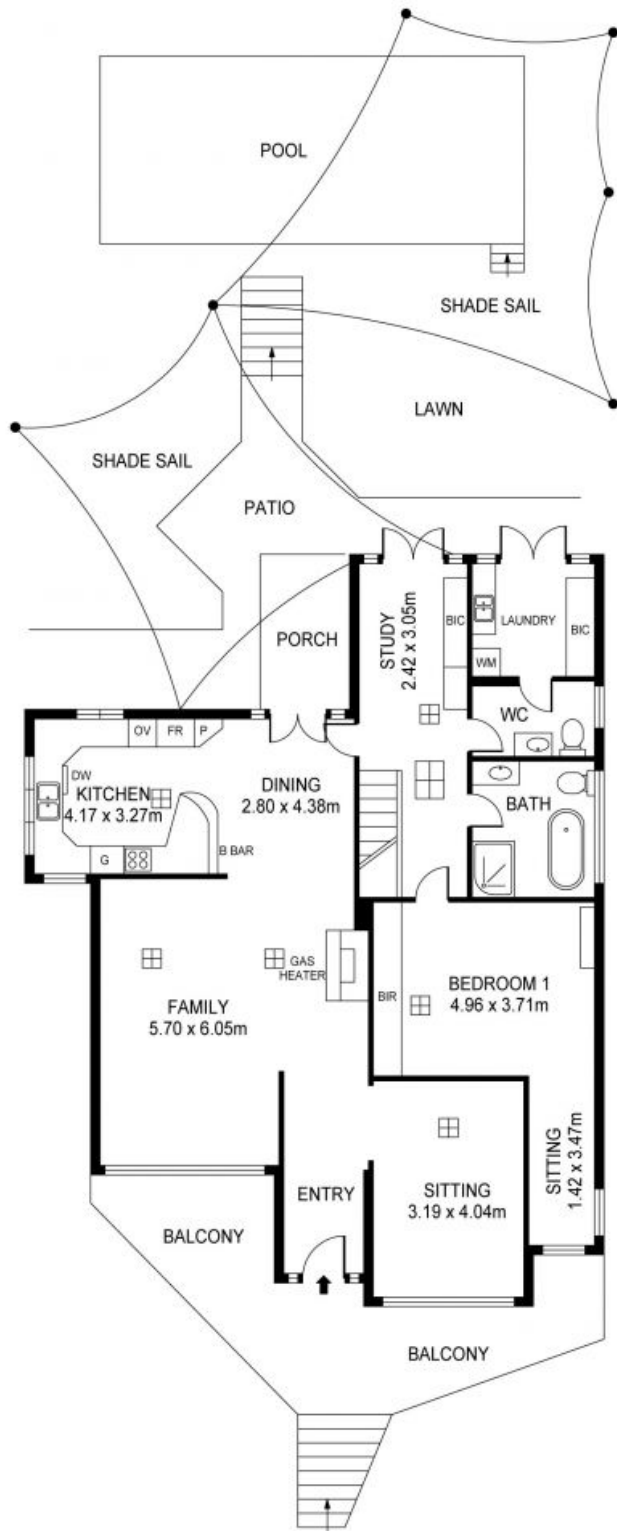

GROUND LEVEL - 137 SQM



LOWER LEVEL - 144 SQM

12 GORDO AVENUE, WATTLE PARK
 APPROX. GROSS INTERNAL FLOOR AREA 281 SQ M



Plans shown are only indicative of layout. Dimensions are approximate.

Wattle Park, SA
 12 Gordo Avenue